

Flowline Model	A	B	C	D	E	F	G	H	I*	J*	K*	L*	M	N	Z	AIR
20-0050	1.18	3.15	1.12	1.44	2.36	2.79	2.05	0.79	1.417 (F03)	1.969 (F05)	M5x8	M6x10	0.55	0.43	4.72	1/4"NPT
20-0075	1.18	3.15	1.18	1.63	2.83	3.62	2.56	0.79	1.417 (F03)	1.969 (F05)	M5x8	M6x10	0.55	0.43	5.79	1/4"NPT
20-0075	1.18	3.15	1.18	1.63	2.83	3.62	2.56	0.79	1.65 (F04)		M5x10		0.55	0.43	5.79	1/4"NPT
20-0100	1.18	3.15	1.42	1.85	3.44	3.83	2.83	0.79	1.969 (F05)		M6x10		0.71	0.55	6.61	1/4"NPT
20-0100	1.18	3.15	1.42	1.85	3.44	3.83	2.83	0.79	1.65 (F04)	2.756 (F07)	M5x10	M8x12	0.71	0.55	6.61	1/4"NPT
20-0150	1.18	3.15	1.65	2.09	3.92	4.72	3.19	0.79	1.969 (F05)	2.756 (F07)	M6x10	M8x12	0.71	0.55	7.24	1/4"NPT
20-0200	1.18	3.15	1.81	2.24	4.28	5.09	3.62	0.79	1.969 (F05)	2.756 (F07)	M6x10	M8x12	0.83	0.67	8.03	1/4"NPT
20-0300	1.18	3.15	1.97	2.40	4.59	5.39	3.86	0.79	2.756 (F07)	4.016 (F10)	M8x12	M10x16	0.83	0.67	10.31	1/4"NPT
20-0400	1.18	3.15	2.26	2.52	5.24	6.06	4.31	0.79	2.756 (F07)	4.016 (F10)	M8x12	M10x16	1.02	0.87	10.55	1/4"NPT
20-0500	1.18	3.15	2.66	2.93	6.10	6.92	5.02	0.79	2.756 (F07)	4.016 (F10)	M8x12	M10x16	1.02	0.87	11.85	1/4"NPT
20-0600	1.18	3.15	2.95	3.03	6.77	7.59	5.41	0.79	4.016 (F10)	4.921 (F12)	M10x16	M12x20	1.22	1.06	15.51	1/4"NPT
20-0700	1.18	3.15	3.43	3.43	7.76	8.93	6.22	1.18	4.016 (F10)	4.921 (F12)	M10x16	M12x20	1.22	1.06	18.03	1/4"NPT
20-0800	1.18	5.12	4.06	4.06	9.06	10.27	7.44	1.18	4.016 (F10)	4.921 (F12)	M10x16	M12x20	1.57	1.42	20.79	1/4"NPT
20-0900	1.18	5.12	4.44	4.44	10.04	11.26	8.31	1.18	4.016 (F10)	5.512 (F14)	M10x16	M16x25	1.57	1.42	20.94	1/4"NPT
20-1000	1.18	5.12	5.12	5.12	11.38	12.67	9.65	1.18	4.016 (F10)	5.512 (F14)	M10x16	M16x25	1.97	1.81	23.70	1/4"NPT
20-2000	1.18	5.12	5.79	5.79	12.83	14.02	10.75	1.18		6.496 (F16)		M20x25	1.97	1.81	28.43	1/2"NPT

Dimension are in inches

## Flow Line Valve and Controls, Inc.

PO Box 677, 110 Main Project Rd. Schriever, LA 70395 · Phone: 985-414-6004 · Fax: 985-414-6072  
[www.flowlinecontrols.com](http://www.flowlinecontrols.com)

Revision: N/A  
 Date: 12-15-17



**3000 & 4000  
 Actuator**

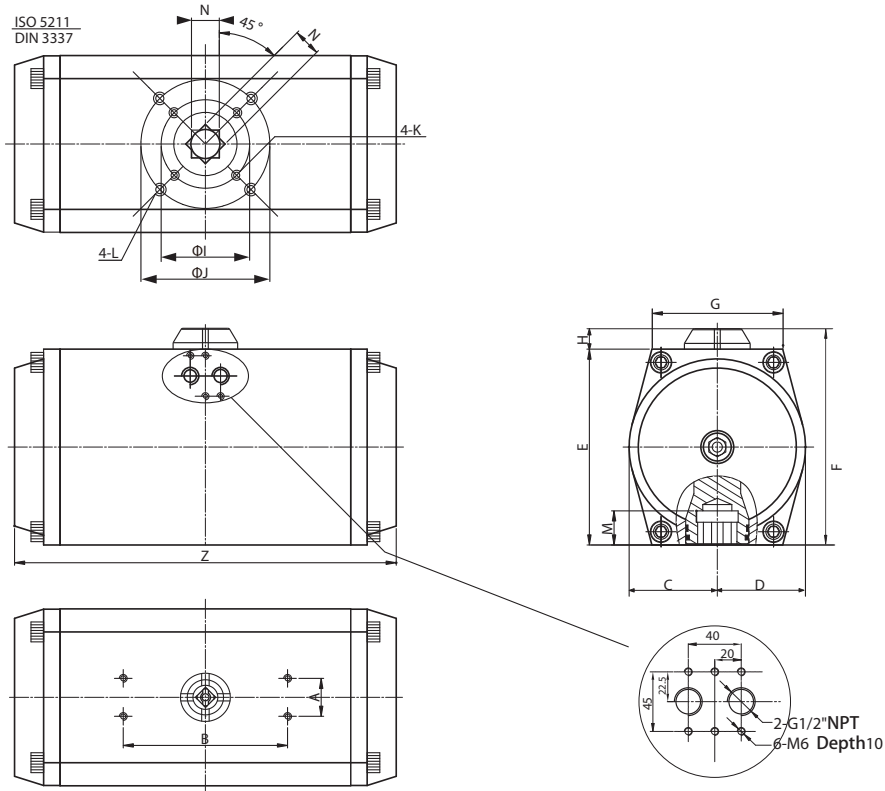

**5000 Actuator**

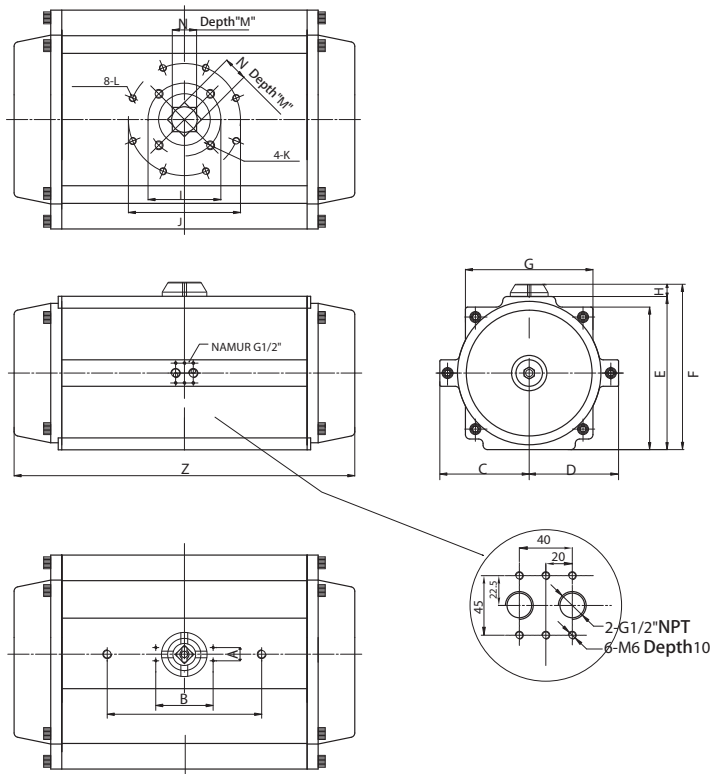

Flowline Model	A	B	C	D	E	F	G	H	I*	J*	K*	L*	M	N	Z	AIR
20-3000	1.18	5.12	6.39	6.39	13.70	14.88	7.72	1.18	6.496 (F16)	8.46(Φ215)	M20X25	M20X30	2.36	1.81	29.41	1/2"NPT
20-4000	1.18	5.12	7.48	7.48	16.06	17.24	8.66	1.18	6.496 (F16)	8.46(Φ215)	M20X25	M20X25	2.36	1.81	34.49	1/2"NPT
20-5000	1.18	5.12	10.16	10.16	18.33	19.51	12.99	1.18	6.496 (F16)	10.00 (F25)	M20X25	M16x25	2.36	2.17	36.30	1/2"NPT

Dimension are in inches

## Flow Line Valve and Controls, Inc.

PO Box 677, 110 Main Project Rd. Schriever, LA 70395 · Phone: 985-414-6004 · Fax: 985-414-6072

www.flowlinecontrols.com

Revision: N/A  
 Date: 06-16-22

